

SPECIFICATIONS PERFORMANCE CURVE

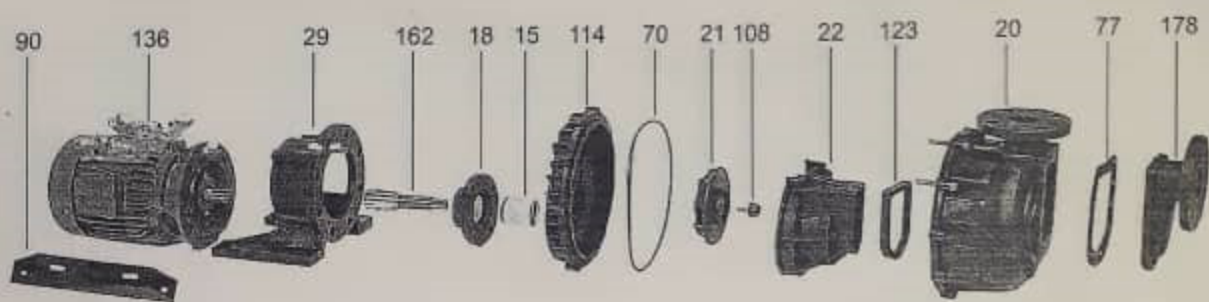

● PD · PD-F Type SPECIFICATIONS

Hz	Type		S.G	Motor			Pump				Weight kg	Height mm	Pump Dia mm
	FRPP	FVDF		Power	Phase	Volt	Bore size		Max. Head	Max. Flow			
	PD	PD-F		KW(HP)	PH	V	Inlet inch(mm)	Outlet inch(mm)	m	m ³ /min			
50	PD-132	PD-132F	1.0	0.75(1)	3	220-480	1 1/2"(40)	1 1/2"(40)	12	0.20	26	374	625
	PD-232	PD-232F	1.0	1.5(2)	3	220-480	1 1/2"(40)	1 1/2"(40)	18	0.36	34	374	704
	PD-332	PD-332F	1.0	2.2(3)	3	220-480	2"(50)	2"(50)	21	0.50	42	374	704
	PD-532	PD-532F	1.0	3.7(5)	3	220-480	2"(50)	2"(50)	26	0.48	56	420	780
	PD-532L	PD-532LF	1.0	3.7(5)	3	220-480	3"(80)	3"(80)	24	0.68	68	425	830
60	PD-132	PD-132F	1.0	0.75(1)	3	220-480	1 1/2"(40)	1 1/2"(40)	10	0.19	26	374	625
	PD-232	PD-232F	1.0	1.5(2)	3	220-480	1 1/2"(40)	1 1/2"(40)	20	0.38	34	374	704
	PD-332	PD-332F	1.0	2.2(3)	3	220-480	2"(50)	2"(50)	24	0.48	42	374	704
	PD-532	PD-532F	1.0	3.7(5)	3	220-480	2"(50)	2"(50)	26	0.60	56	420	780
	PD-532L	PD-532LF	1.0	3.7(5)	3	220-480	3"(80)	3"(80)	28	0.68	68	425	830

● PD · PD-F Type PERFORMANCE CURVE

