

Panatech

CAR RADIO/MP3 PLAYER

app option

User Manual



Remote Function

- | | |
|---------------------|--|
| 1. Power | 9. VOL- |
| 2. Mode | 10. VOL+ |
| 3. Mute | 11. AS/PS |
| 4. Pause/Play | 12. Function setting |
| 5. PREV/Tuning down | 13. Figure keys (1~6) : same operation with panel keys |
| 6. NEXT/Tuning up | 14. The prev 10th MP3 |
| 7. EQ | 15. The next 10th MP3 |
| 8. Clock | |

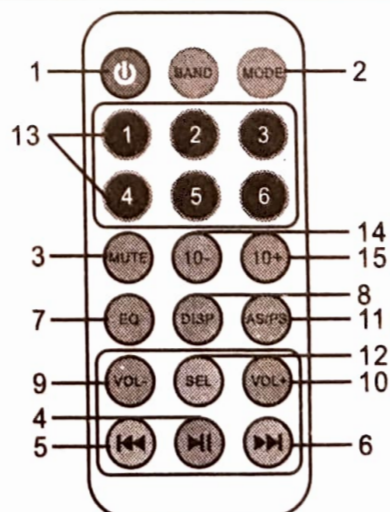

APP Search: Car Radio Remote



IOS



Android



Google Play

Common Faults and Solutions

Symptom	Fault cause	Solution
Power light does not shine	1. The power of positive and negative reversed 2. Disconnect the fuse or power line open	Grafting power, check and connect well the power cord, replace the fuse
No display screen	1. yellow line is not connected to the battery positive. 2. The yellow line fuse disconnect	Ensure the yellow wire is connected to the battery positive. Replace the yellow line fuse
Silent	1. The power cord is bad. 2. The speaker line open. 3. TF card, USB do not have the correct format. 4. TF card, USB connecting finger dirty, bad.	Connect well the power cord and speaker wire, check TF card, USB contents, with anhydrous alcohol to clean the connecting finger.
Sound light (not clear)	1. Power internal resistance. 2. The antenna plug connection is bad	Replace the battery. Seated antenna plug.
Monaural	1. Open a speaker. 2. The amplifier IC bad.	Connect well the speaker wire. In other amplifier IC.



Mobile software features

Qualima

1. Car radio is turned on (manually turned on)
2. Install the car radio remote APP and allow access via APP
3. Open the APP, the APP will pop up the select device dialog box (figure 1), click on your device in the dialog box, the APP will automatically connect, and the connection will be displayed in the upper right corner of the APP. (Figure 2)
4. Click SEL in the APP interface to enter equalizer settings (Figure 3), and press '⏮' to return to the main interface.

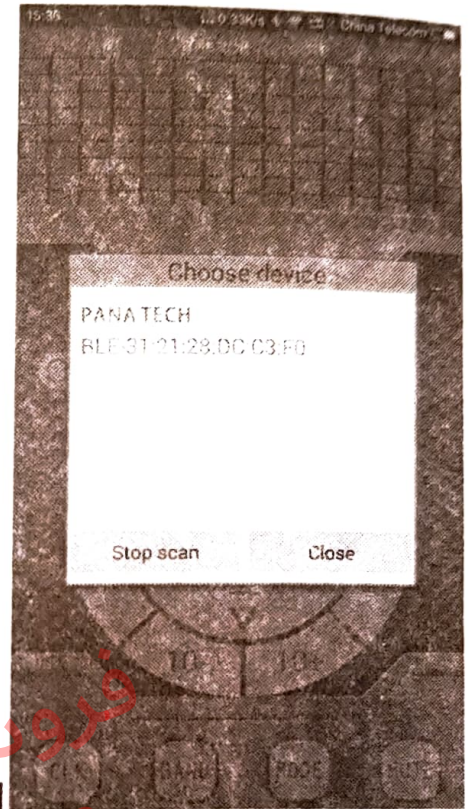

Fig.1

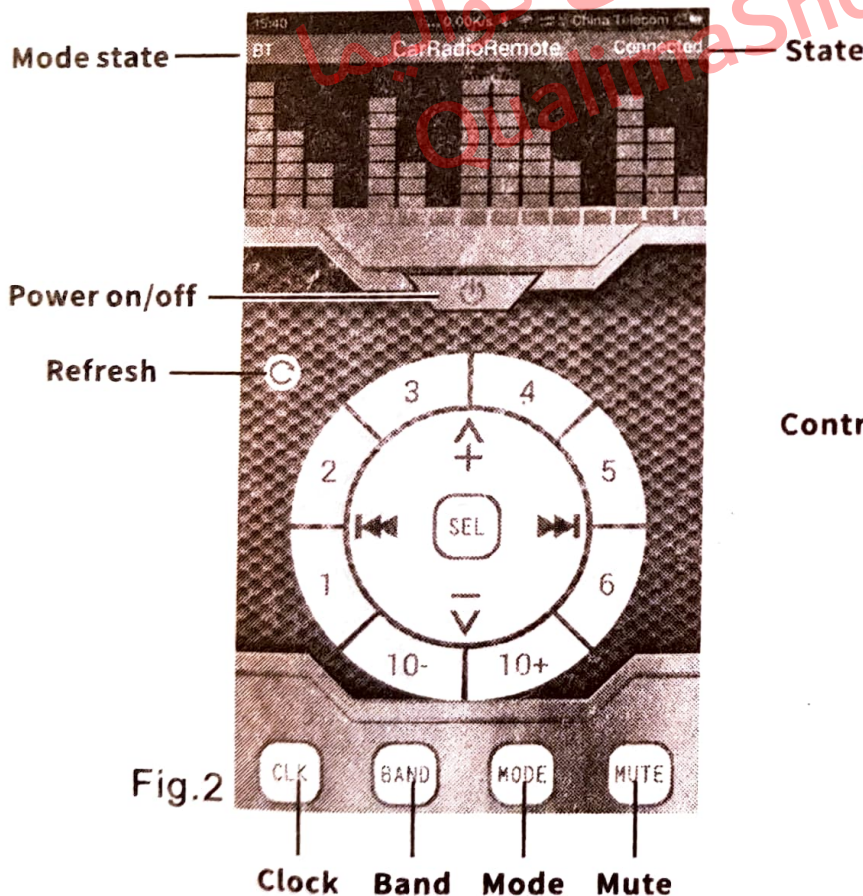

Fig.2

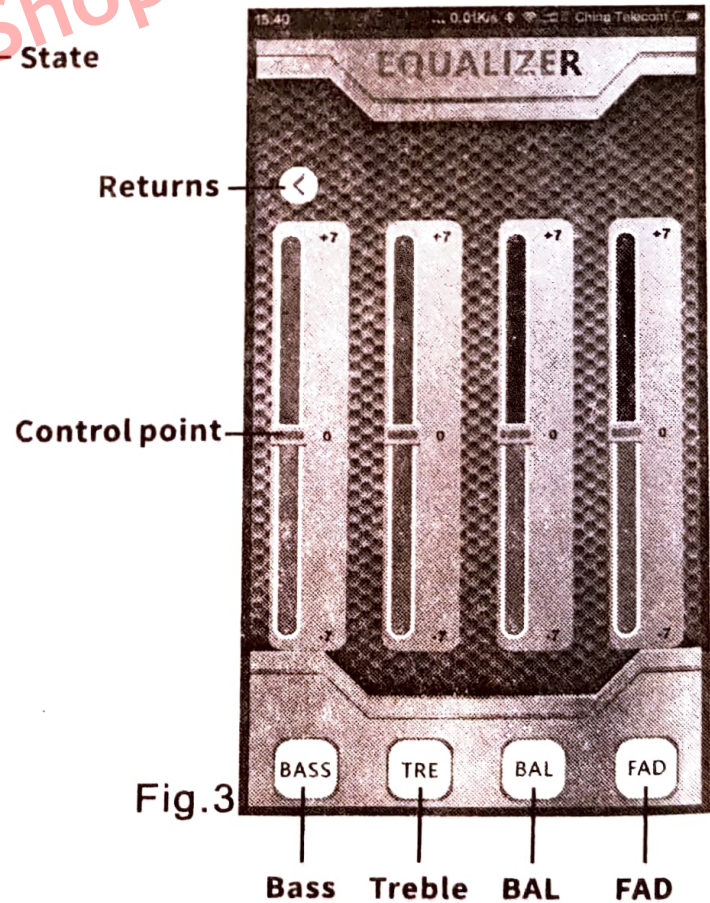
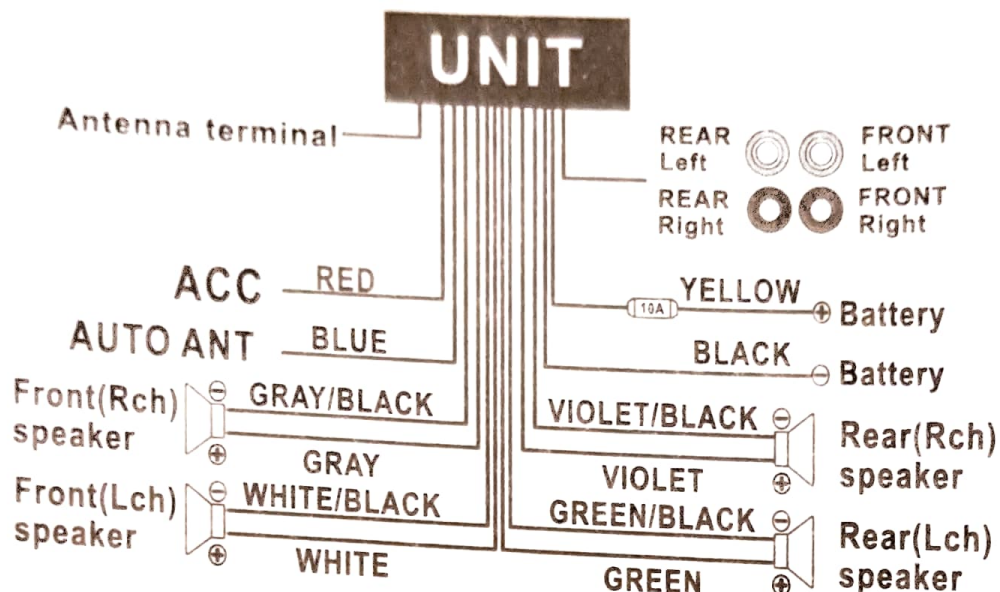

Fig.3



Connection

Qualima



Installation Notes

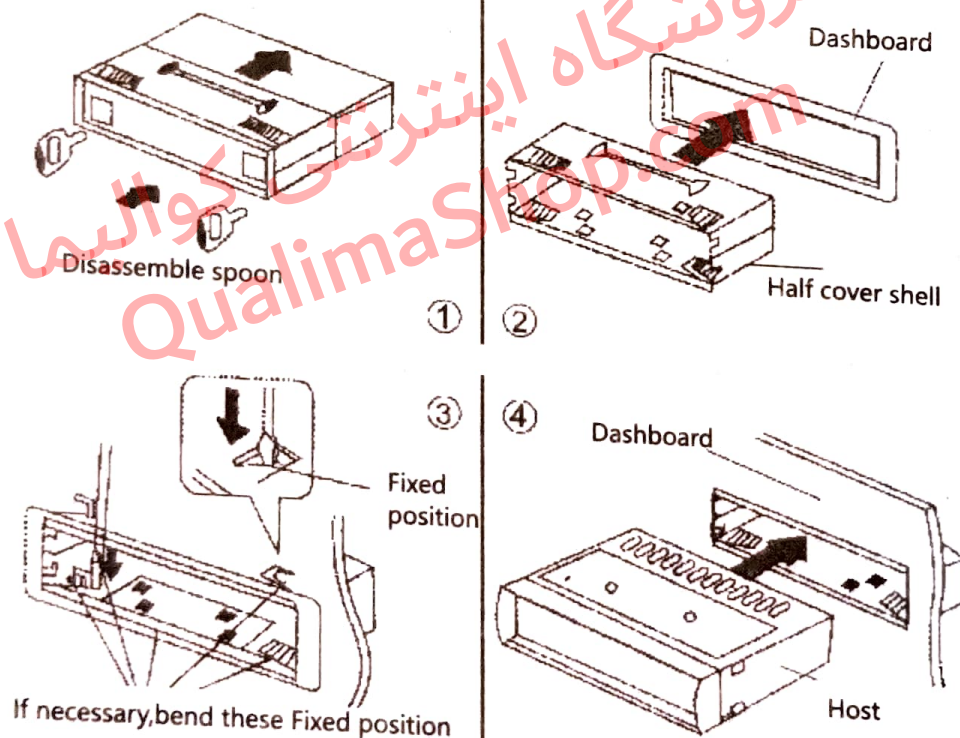

1. Before connecting the device, you must read the operating and installation instructions carefully.
2. This audio should be installed by professional installation master if possible.
3. After the rest of the connection, and then connect the power cord.
4. Insulation of all exposed wires to prevent short circuits.
5. After installation device, requiring secure all loose wires.
6. This audio is only suitable for negative ground systems are detailed on host labels, before installation should make sure your car is belong to this type of negative ground electrical system
7. You must connect depending on the wire color, if there is a connection error, it may cause a malfunction or damage to the vehicle's electrical system

Basic Operation

1. Short press POW/MOD is turn on. After turn on, short press is switch mode, long press is turn off. Mode switch order is: radio- USB- TF card- AUX, then back to radio.

2. Volume adjustment (Volume knob) - clockwise to increase the volume, counter-clockwise to decrease the volume.

3. Treble and bass sound adjustment Bass sound adjustment -short press the volume knob, when the display shows "BAS", clockwise the volume knob to increase bass volume and counter-clockwise to decrease the bass volume. The bass adjustment range: -7~+7 Treble sound adjustment -short press the volume knob twice, when the display shows "TRE", clockwise the volume knob to increase treble volume and counter-clockwise to decrease the treble volume. The treble adjustment range: -7~+7

4. Volume function button SEL adjustment- sequence of pressing button: BASS→TRE→BAL→FAD→EQ→Mega Bass, you may change mode with pressing the button as the display shows.

Radio Operation

1. Band switching: This audio have band FM1、FM2、FM3 , In FM mode , short press the "BAND" button to change FM band: FM1→FM2→FM3 , press again to back to FM1.

2. AMS- Under the radio mode, long press "AMS" button, access to search radio station status automatically, and save all the radio station to the channel accordingly, each band able to save 6 radio station. Short press is look through the radio station.

3. Automatically search station "◀▶" -In radio mode , press the selection button to search stations automatically up and down , the audio will stop searching and playback the current station when find it.

4. Manually search station- Long press "◀▶" -In radio mode , the audio into manual search station mode , and manually search for radio stations up or down quickly.

5. Manually store station (Figure 1~6) -In radio mode, searched through automatically or manually for radio stations, press any key from key 1-6 , you can store the current station.

6. Preset radio play (key 1-6) - In radio mode, press any key from key 1-6, you can play the corresponding stored station.

Playback Operation

1. Single selections "◀▶" , -In MP3 mode , to achieve previous and next selection.

2. The ten selected songs in MP3 mode, you can short press the button of 5-10/6+10, to choose the previous or next 10 songs.

3. Pause playback: in MP3 mode, you can short press the button of "1/⏸" to pause playing. The LCD display shows "PAUSE" , you can press again, then it will continue to play.

4. Browse playback: in MP3 mode, you can short press the button of 2/INT to introscan. (It will play ten seconds of every song.) If during the playing process, you press this button again, it will stop and start playing the current song.

5. Repeat playback: in MP3 mode, you can short press the button of 3/RPT to repeat to the single song. You press again, it will cancel the repeat mode.

6. Random playback: in MP3 mode, you can short press the button of 4/RDM to random play. You press again, it will cancel the song to random play.

Clock Operation

In the state of power-on, short press CLK button, to display clock 00:00, then long press CLK button, the hour digit flashing display, rotate the volume knob to adjust hour digit. Press again CLK button , display conversion adjust minutes digit , rotate the volume knob to adjust minute digit. Long press CLK button for 5 seconds to back to the display before setting. This audio is 24-hour clock.

Other Operation

External audio line input (AUX IN) control, short press "MODE", can be switched to an external audio input mode and display AU, connect an external audio device, then can begin to play.

Panel color light difference operation

Under turn on status, short press "SEL" button (the middle of the volume button), shows 'AUDIO', now spin the volume button can select auto-change color.

BT Operation

1. When it is in the state of power-on, Bluetooth had already launched in the background and it can be discovered and paired by other devices. The Bluetooth named "PANA TECH". Press MODE button, it will change to Bluetooth Mode (shown as "BT"). If it is not in the state of connecting Bluetooth, "BT" will be blink. Instead, it will be normally on.
2. After connecting with Bluetooth and changing the mode to "BT", you can play your mobile music and video. Button "◀" and "▶" can control the PREV and NEXT song of your mobile phone. Besides, "PLAY" means PLAY/PAUSE of your mobile.
3. In the state of connecting with mobile Bluetooth, press "MODE" button, then it will change to other mode and automatically pause the song from your mobile, but still run in the background.
4. If it is still connecting with the Bluetooth, in the state of any mode (MP3\FM\LINE\BT), if someone calls you up, it will stop the current mode and change to BT mode automatically and the display screen will show the phone number who calls you up. Then press "END" button to hang up and press "END" for answering the phone. After hanging up, it will come back to normal mode.

Technical Parameters

FM part	
Frequency range	87.5MHz~108MHz
Noise limited sensitivity	≤25dBf
SNR	≥40dB
Stereo separation	≥20dB
MP3 playback	
Support format	MP3
Music vector	USB/TF card
Frequency response	(100Hz~15KHz) ±8dB
SNR	≥50dB
Channel isolation	≥35dB
Voltage harmonic distortion (1KHz)	≤1%
Playback stereo channels balance	1dB
Audio part	
Voltage	DC 12V
Max output power	12V 15x4W(50X4W)
Speaker impedance	4~8Ω
Audio size	W x H x D (178x50x125mm)