



DOOR FITTINGS

FOR COMMERCIAL USE

CATALOGUE
2019-2020

SARO GLOBAL®



PANIC EXIT DEVICE

ONE-POINT PUSH TYPE, RIM VERSION



OUTSIDE HANDLE

OTI 011302006

Black



ETI 011301011

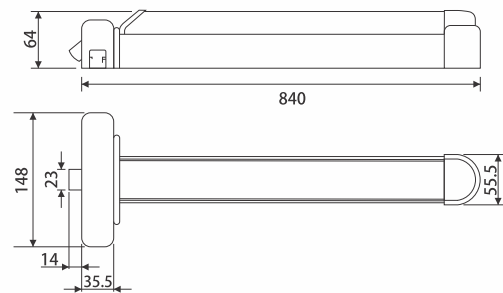
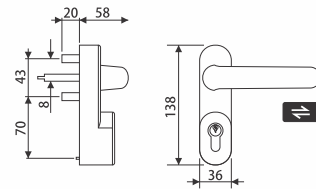

Specification :



- Certificate of quality : CE
- EN 1125 : 2008 certified
- Reversible (L and R hand)
- Body Color : Black & Red painted

Fire Rated



PANIC EXIT DEVICE

MODULAR PUSH TYPE, RIM VERSION



OUTSIDE HANDLE

OTI 011302006

Black



ET3 011303007

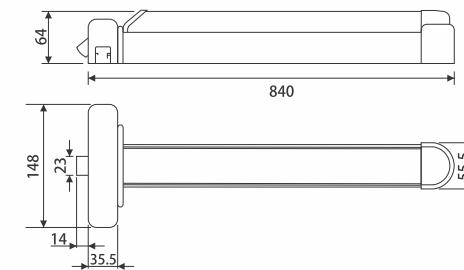
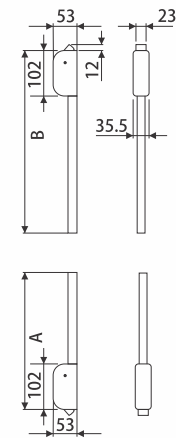

Specification :



- Certificate of quality : CE
- EN 1125 : 2008 certified
- Reversible (L and R hand)
- Body Color : Black & Red painted

Fire Rated



PANIC EXIT DEVICE

ONE-POINT BAR TYPE, RIM VERSION



OUTSIDE HANDLE

OTI 011302006

Black

EBI 011301012



Specification :



- Certificate of quality : CE
- EN 1125 : 2008 certified
- Reversible (L and R hand)
- Body Color : Black & Red painted

Fire Rated

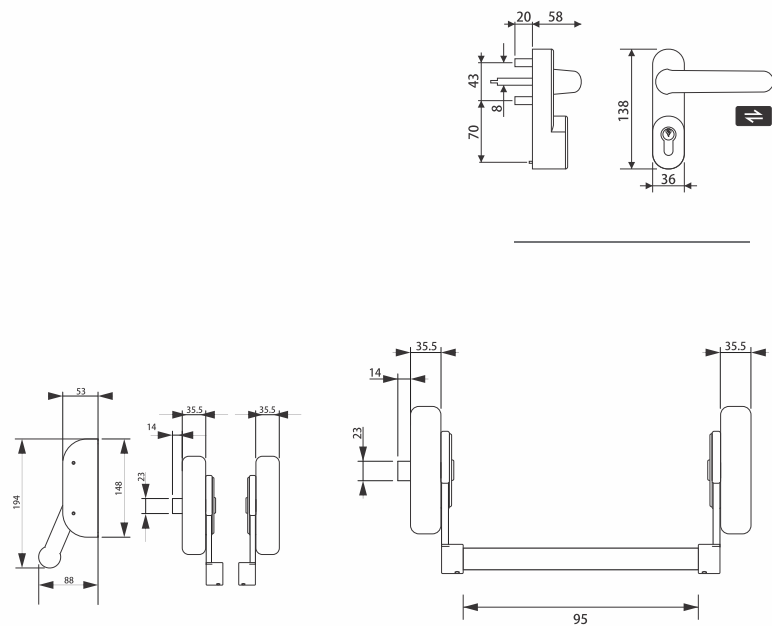

PANIC EXIT DEVICE

MODULAR BAR TYPE, RIM VERSION



OUTSIDE HANDLE

OTI 011302006

Black

EB3 011303008

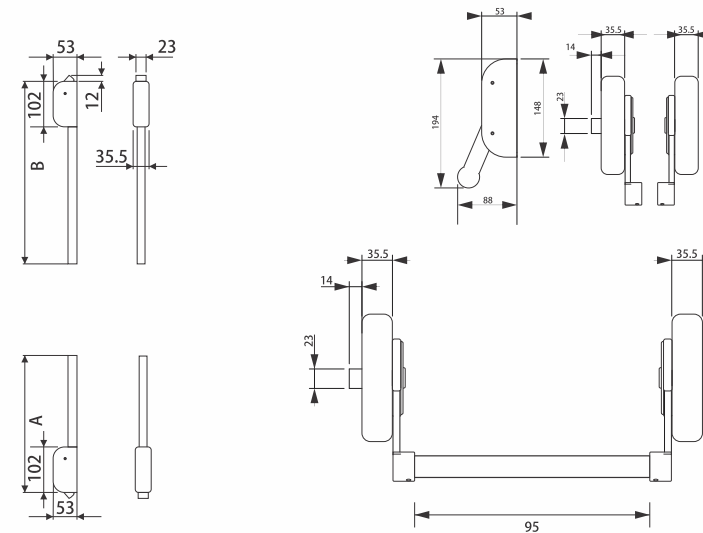

Specification :



- Certificate of quality : CE
- EN 1125 : 2008 certified
- Reversible (L and R hand)
- Body Color : Black & Red painted

Fire Rated



PANIC EXIT DEVICE

ONE-POINT PUSH TYPE, RIM VERSION

Exi-Touch 1-point



MADE IN TAIWAN



Specification :

- UL Tested
- ANSI Certified, Grade I
- Reversible (L and R hand)
- Body Color : Black & Red, Silver, Stainless Steel



Fire Rated



Name	Type	Material	Finish	Item NO
Exi-touch 1	Fire Rated	Stainless Steel	Satin StainlessSteel	011301009
		Steel	Black & Red	011303005
Exi-touch 2	Panic Rated	Steel	Black & Red	011301003
		Steel	Silver	011301008

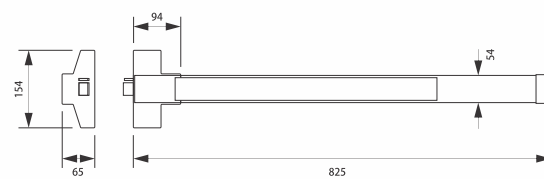

PANIC EXIT DEVICE

TWO-POINT PUSH TYPE, RIM VERSION

Exi-Touch 2-point



MADE IN TAIWAN



Specification :

- UL Tested
- ANSI Certified, Grade I
- Reversible (L and R hand)
- Body Color : Black & Red



Fire Rated

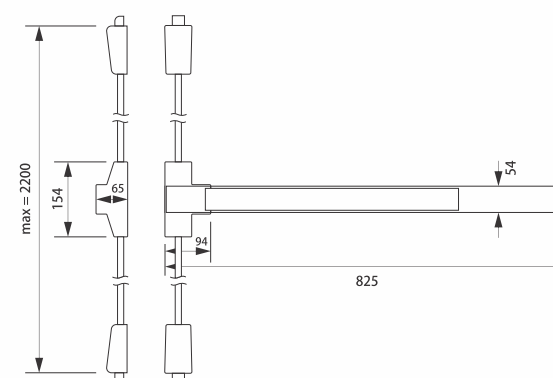

Name	Type	Material	Finish	Item NO
Exi-touch 12	Fire Rated	Steel	Black & Red	011303006
Exi-touch 22	Panic Rated	Steel	Black & Red	011301004

DOOR HANDLE FOR PANIC EXIT DEVICE



Exout-2 B 011302007

Black painted



Exout-2 SS 011302010

Stainless Steel

Specification :

- Reversible (L and R hand)
- Body Color : Black, Stainless Steel



Exi-Touch suitable handles

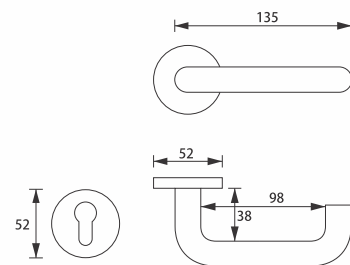

OUTSIDE HANDLE FOR PANIC EXIT DEVICES



Exout I/BR 011302004

Black painted

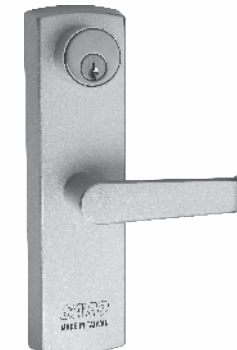

Exout I/S 011302003

Silver painted



Exout I/SS 011301006

Satin Chrome Plated

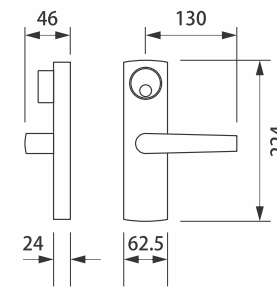

MADE IN TAIWAN



Specification :

- Reversible (L and R hand)
- Body Color : Black, Silver, Satin Chrome



Exi-Touch suitable handles

ELECTRIC STRIKE FOR PANIC EXIT DEVICES

ESP01 010221006

Mechanical features :

- Reversible
- Front Plate : Anodized Aluminum
- Deadlocking tab for latch with 3 mm side regulation.

Electric features :

- 12 V AC & DC
- Fail Secure



DOOR COORDINATOR FOR REBATED DOORS

DC-01 011301007 Size : 9"

DC-02 011301013 Size : 7"

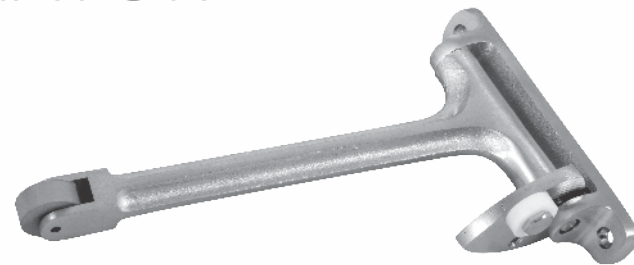

Specification :

- For rebated doors
- Material : Stainless Steel
- Reversible (L and R hand)
- Prevent the active door from closing until the inactive door is closed.



ACCESSORIES FOR PANIC EXIT DEVICES

Exi-Touch Accessories

Type	Name	Item NO.
Top Rod (For 2-point rim type)	Top Rod 300	012028001
Fire Rated Strike Full Pack	-	011526001
Panic Rated Strike Full Pack	-	011525001
Thick Door Kit (+10 mm)	Extension Kit 1	010114005
Thick Door Kit (+35 mm)	Extension Kit 3	010114006
Thick Door Kit (+55 mm)	Extension Kit 4	010114007



Extension Kit 1



Extension Kit 3



Extension Kit 4

STRIKE FOR PANIC EXIT DEVICES - FLAT & REBATED DOORS

Strike 010221001



DOOR HANDLE COMMERCIAL

LHT01-G3 010106013

Grade. 3
Medium Duty

LHT01-G4 010106014

Grade. 4
Heavy Duty

Specification :

- Stainless Steel 304
- For commercial use
- With more than 200.000 times lifetime test
- **EN 1906** Certified

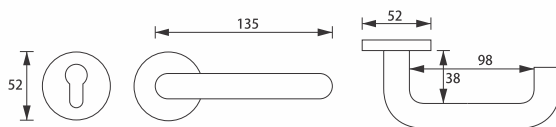

PHT-01 010112011

Medium Duty

Specification :

- Stainless Steel 304
- For commercial use

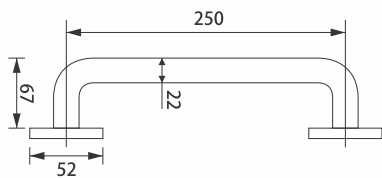

SARO[®]

SARO GLOBAL[®]

MORTISE LOCK TOP SECURITY

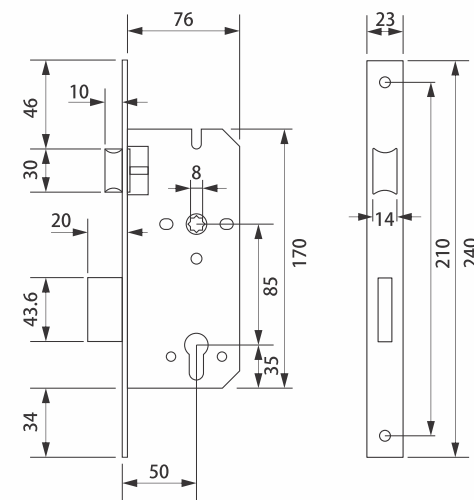

MLI

STAINLESS STEEL

Specification :

- Backset : 45, 50 mm
- Finish : Satin Nickel, Gold Plated, Antique Brass
- Follower : 8 x 8 mm
- Latch material : Brass
- All Stainless Steel 304



Name	Backset	Type	Finish	Item NO
MLI/45	45 mm	Cylinder type	Matt Gold Plated	020204004
MLI/50 SS	50 mm	Cylinder type	Stainless Steel	020204002
MLI/50 AB	50 mm	Cylinder type	Antique Brass	020204008
MLI/50 PVD	50 mm	Cylinder type	Gold PVD	020204009

SARO GLOBAL[®]

Lombardi[®]

DOOR HINGE COMMERCIAL

Flush 4 SS 010314002

Stainless Steel



STAINLESS STEEL

Specification :

- Loose-Pin
- Thickness : 2.5 mm
- Width : 3 inches
- Stainless Steel
- For commercial use
- With more than 200.000 times lifetime test

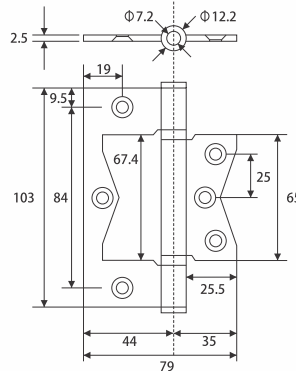

SARO[®]

SARO GLOBAL[®]

DOOR HINGE COMMERCIAL



Flat-H 44 010311014

Size 4 - Width 4 inches



Flat-H 43 010311013

Size 4 - Width 3 inches

Flat-H 43

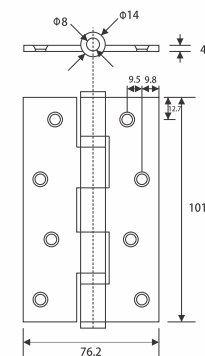

Flat-H 44

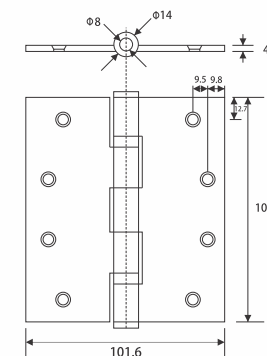

Specification :

- Loose-Pin
- Thickness : 2.5 mm
- Stainless Steel
- Fire Resistant - Up to **60** min
- **EN 1935** Certified
- For commercial use
- With more than 200.000 times lifetime test

Fire Rated



SARO[®]

SARO GLOBAL[®]

DOOR CLOSER

FIRE RESISTANT

DCO501/S 010701011 Silver

DCO502/B 010701012 Black

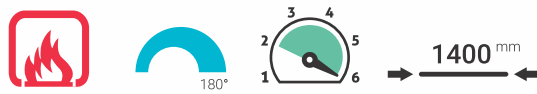

Specification :

- Adjustable Size : EN2~EN6
- Door Weight : **40~120** kg
- Certificate of quality : CE
- **EN 1154 , EN 1634** Certified
- Maximum Door Width : 1400 mm
- Standard & Parallel Arm
- Fire Rated
- Finish : **Silver , Black**

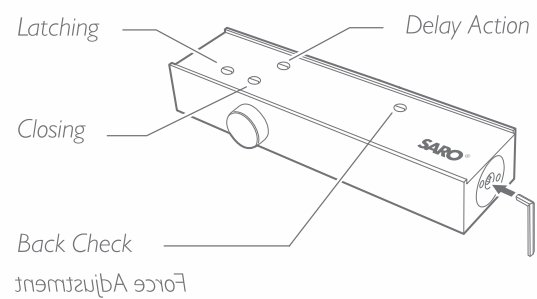

+ Parallel Arm



SARO[®]

SARO GLOBAL[®]

DOOR CLOSER

COMMERCIAL

DCT25H/S 010701006

Silver / with hold-open arm

DCT25H/B 010701007

Black / with hold-open arm

DCT25P/S 010701008

Silver / with standard & parallel arm

DCT25P/B 010701009

Black / with standard & parallel arm

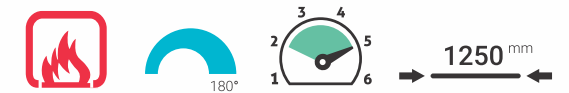

Specification :

- Adjustable Size : EN2~EN5
- Door Weight : **40~100** kg
- Certificate of quality : CE
- **EN 1154 , EN 1634** Certified
- Maximum Door Width : 1250 mm
- Standard and Parallel Arm / Hold Open Arm
- Fire Rated * (Standard & Parallel Arm Only)
- Finish : **Silver , Black**



+ Parallel Arm

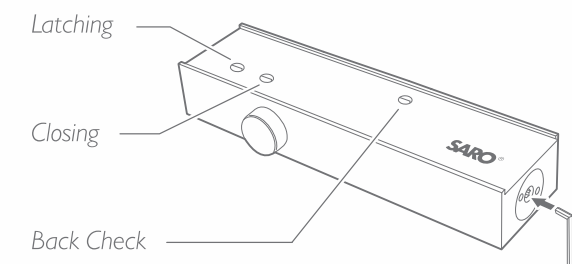

SARO GLOBAL[®]

SARO[®]

DOOR CLOSER COMMERCIAL

DCT25P/G 010701014 Gold

DCT25P/SS 020701016 Stainless Steel



Specification :

- Adjustable Size : EN2~EN5
- Door Weight : **40~100** kg
- Certificate of quality : CE
- **EN 1154 , EN 1634** Certified
- Maximum Door Width : 1250 mm
- Standard and Parallel Arm
- Fire Rated
- Finish : **Gold, Stainless Steel**

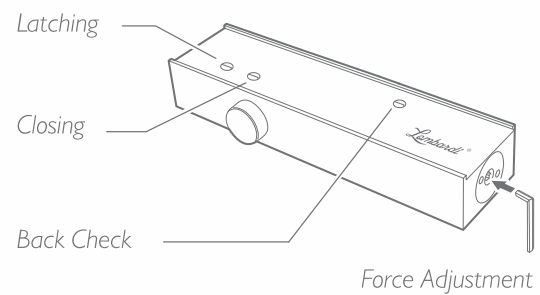

+ Parallel Arm



Lombardi®

SARO GLOBAL®

DOOR CLOSER RESIDENTIAL

DCO40I 010701010

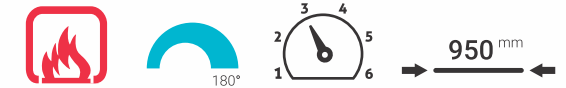

Specification :

- Size : EN3 (Door Weight : **60** kg)
- Certificate of quality : CE
- **EN 1154 , EN 1634** Certified
- Maximum Door Width : 950 mm
- Linear Arm + Fit Arm Mechanism
- Fire Rated
- Finish : **Silver** painted



Note:

Hold-open part shall be removed on fire doors.

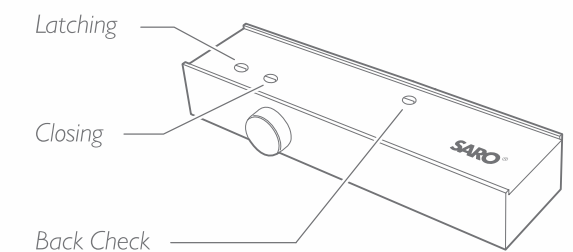

SARO GLOBAL®

SARO®

DOOR CLOSER RESIDENTIAL

DCO601/S 010701013 Silver

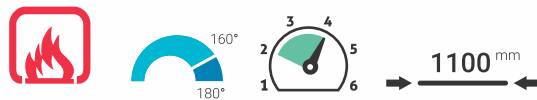

Specification :

- Size : EN2, EN3, EN4 (Door Weight : 40~80 kg)
- **UL 228 , UL 10C** Certified
- Maximum Door Width : 1100 mm
- Standard & Parallel Arm
- Fire Rated
- Finish : **Silver**



Size :	2	3	4
Max. Door Width	870	950	1100
Max. Opening Angle	180	180	160

+ Parallel Arm



SARO GLOBAL®

SARO®

DOOR CLOSER RESIDENTIAL

Silver **DCT234/S** 010701004

Black **DCT234/B** 010701005

Gold **DCT234/G** 010701015



Specification :

- Size : EN2, EN3, EN4 (Door Weight : 40~80 kg)
- **UL 228 , UL 10C** Certified
- Maximum Door Width : 1100 mm
- Standard Arm
- Fire Rated
- Finish : **Silver, Black and Gold**



Size :	2	3	4
Max. Door Width	870	950	1100
Max. Opening Angle	160	160	145

SARO GLOBAL®

SARO®

DOOR CLOSER DRAWING

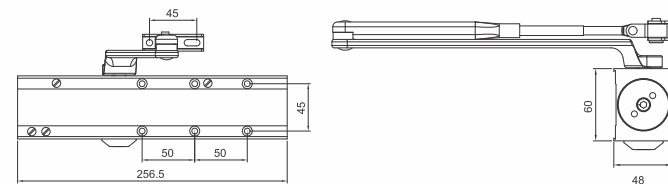

DCO501/502

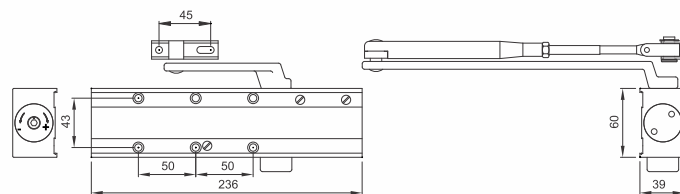

DCT25H/P

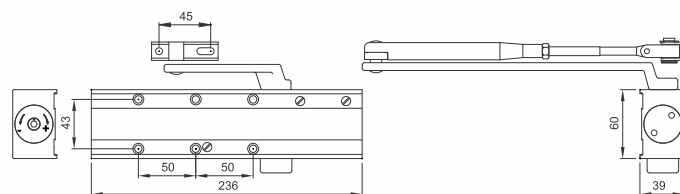

DCT25G

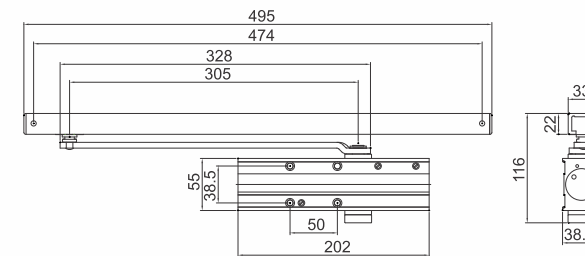
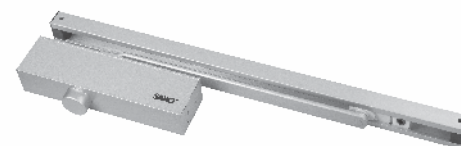

DCO401

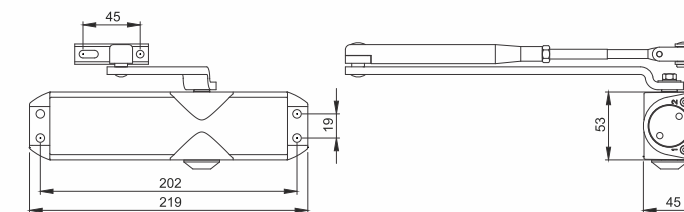

DCO601

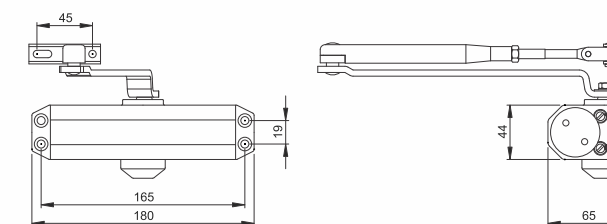

DCT234