

Imou

Quick Start Guide

V1.0.2

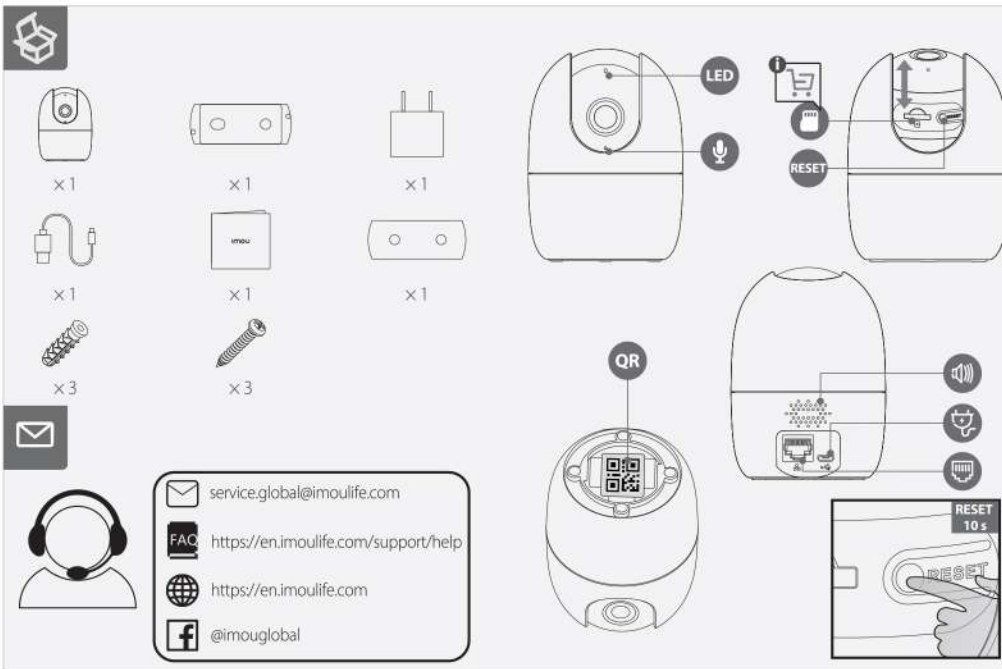
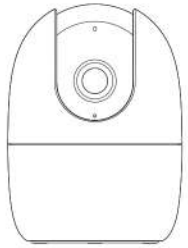

1 Power On the Camera

Connect the camera to power. You can choose wireless or wired network connection (see part 1).

2 Get the Imou Life App

Scan the QR code on part 2 or search for "Imou Life" to download and install the app. Create an account and log in.

3 Set Up the Camera

Scan the QR code on the body of the device or on the cover of this guide with the app, and then follow on-screen instructions to complete the setup (see part 3).

4 Install the Camera

Make sure the mounting surface is strong enough to hold three times the weight of the camera. For detailed installation process, please see part 4.

LED Status	Device Status
Green	Flashing
	Solid
	Ready to set up the device
	Working properly
Red	Flashing
	Solid
	Network disconnected
	Failed to set up the device
	Booting
	Device malfunction
Green & Red	Alternating
Off	/
	Updating firmware
	Power off
	LED turned off

1 If you need to reset the camera, press and hold the reset button for 10 s. The LED turns solid red when the camera is booting.

